



Florida Department of Transportation  
**DISTRICT SIX CONSTRUCTION**  
Miami-Dade & Monroe counties



### State Road (S.R.) 25/U.S. 27/Okeechobee Road Corridor Wide Construction Update

Below is a list of upcoming and ongoing construction activities and lane closure information for each project segment.

#### CONTINUOUS LANE CLOSURE ALONG NW 95 STREET

Starting **tonight, March 20, 2026, at 9 p.m.**, travel lanes in both directions along NW 95 Street between Frontage Road and NW 80 Avenue will be closed to traffic continuously. Travel lanes are expected to open on **Monday, March 30, 2026, at 5:30 a.m.** This closure is necessary for the reconstruction of NW 95 Street.

For the complete traffic pattern, click [here](#).

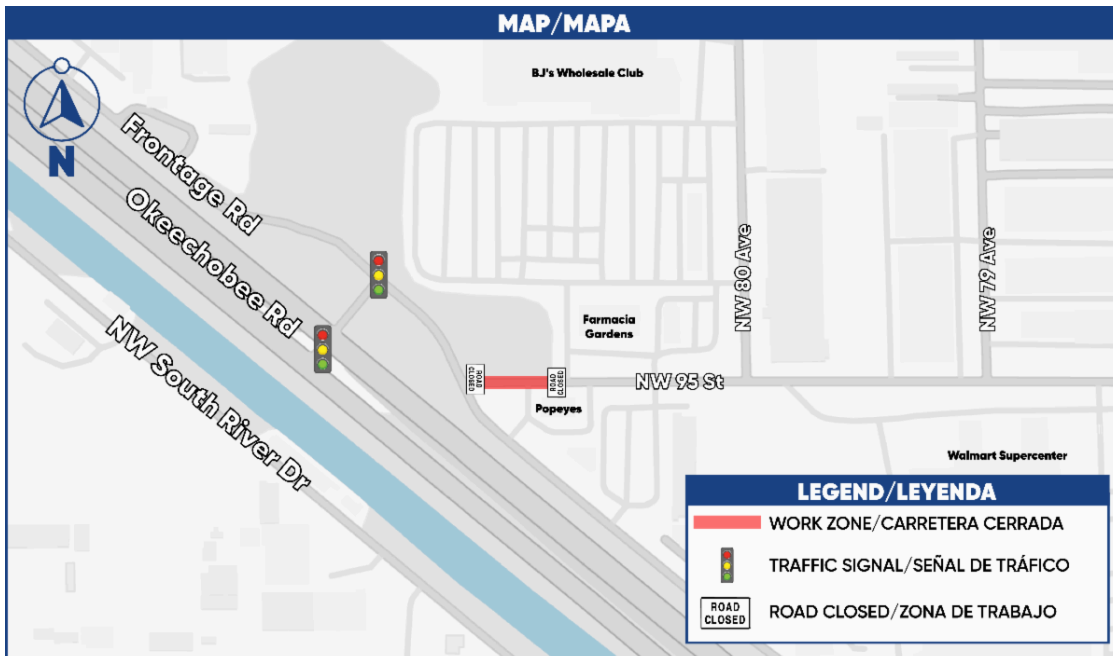

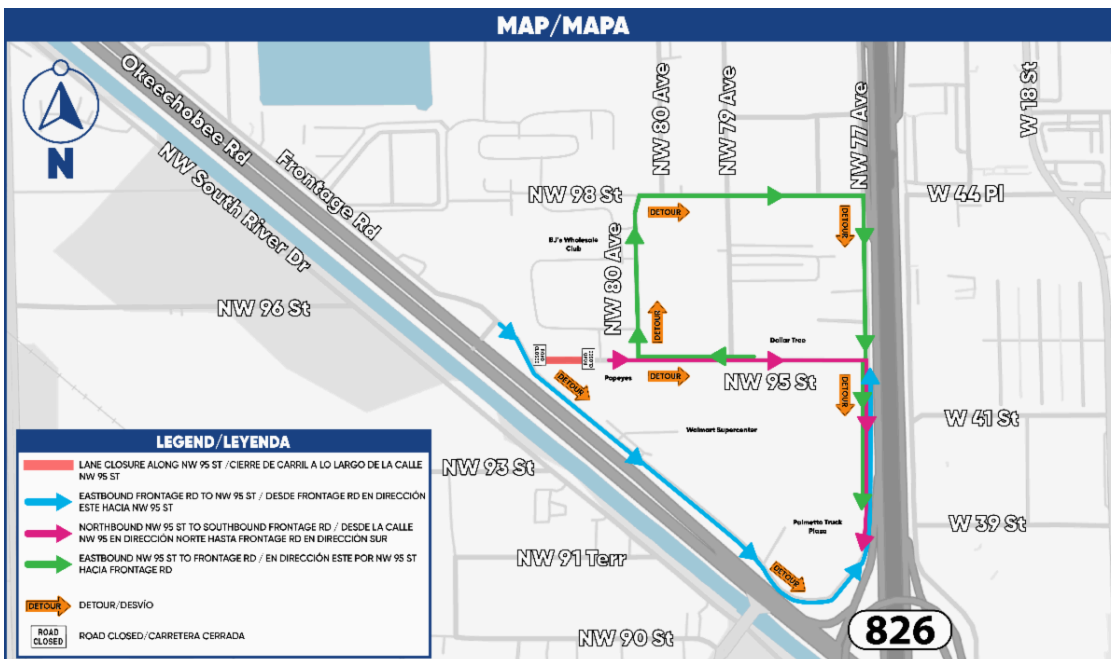

### NIGHTTIME CLOSURE ALONG NW SOUTH RIVER DRIVE

Crews will continue bridge demolition over the northbound S.R. 826/Palmetto Expressway off-ramp bridge to S.R. 27/U.S. 25/Okeechobee Road. To complete this work, travel lanes in both directions along NW South River Drive between the northbound S.R. 826/Palmetto Expressway off ramp and W 18 Avenue will be closed beginning on **Monday, March 23 until Monday, March 30, 2026**. Travel lanes will be closed nightly at 11 p.m. and reopen daily by 5:30 a.m. the following day.

For the complete traffic pattern, click [here](#).

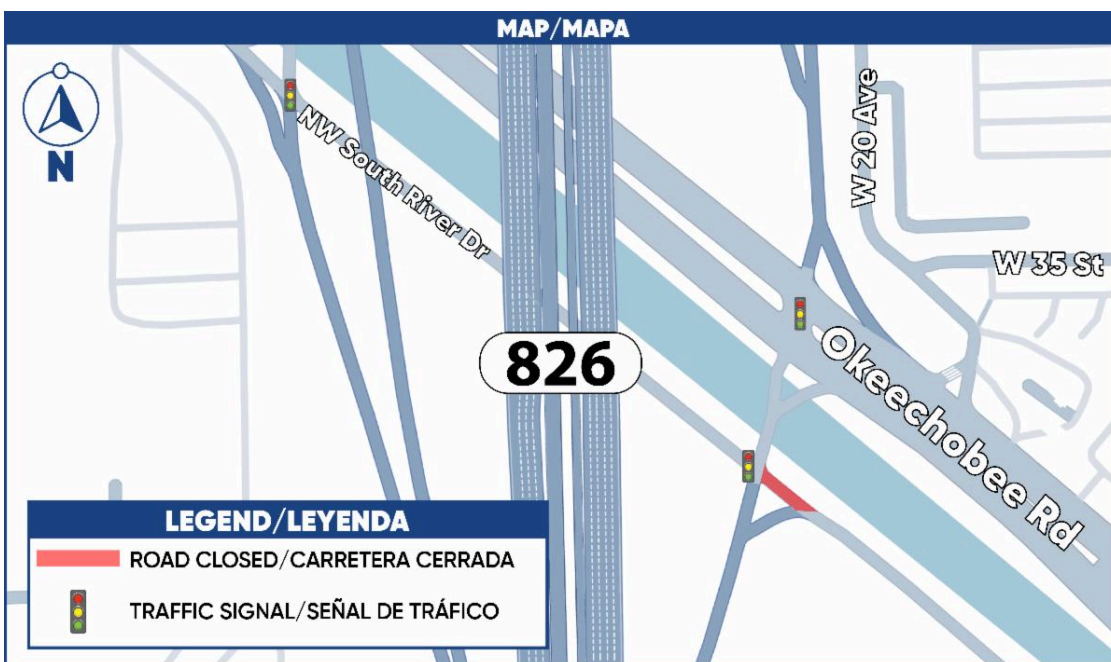

### TRAFFIC SHIFT AT NW 79 AVENUE BRIDGE

Southbound travel lanes on the NW 79 Avenue bridge at NW South River Drive will be shifted to the east beginning **Tuesday, March 31, 2026**. This shift is necessary to allow crews to perform bridge widening work.

## **CLOSURE ALONG FRONTAGE ROAD BETWEEN NW 79 AVENUE AND NW 77 AVENUE**

Travel lanes in both directions along Frontage Road between NW 79 Avenue and NW 77 Avenue will be closed from **11 p.m. on Friday, April 3, through Monday, April 6, 2026**, for reconstruction. Access to driveways and businesses will be maintained at all times.

---

### **ONGOING CONSTRUCTION ACTIVITIES**

#### **Segment Three: From east of NW 87 Ave to NW 74 St, including Palmetto Expy.**

- Performing drainage work along S.R. 25/U.S. 27/Okeechobee Rd, Frontage Rd, NW South River Dr, and NW 79 Ave.
- Installing and performing the following:
  - Curb and gutter, sidewalk, excavation, roadway base, signalization work along Frontage Rd.
  - Backfilling, barrier walls, lighting, temporary signalization work along Okeechobee Rd.
  - Clearing and grubbing along the canal between NW 95 St and NW 79 Ave for roadway widening.
- Bridge construction at:
  - Okeechobee Rd and NW 79 Ave.
  - Bridge foundations along NW South River Dr between NW 79 Avenue and southbound S.R. 826/Palmetto Expy. on ramp.
  - NW South River Dr. and northbound S.R. 826/Palmetto Expy. off ramp.
  - MSE wall for southbound S.R. 826/Palmetto Expy. on ramp.

During this time, single lane closures may take place along Frontage Rd and Okeechobee Rd in both directions.

Please note, utility companies are also performing relocations efforts along:

- Frontage Rd.
- West 18 Ave.

#### **General Lane Closures**

Closures may take place during the following hours:

- 9 a.m. to 3:30 p.m. weekdays and weekends.
- 9 p.m. to 5:30 a.m. on weekdays.
- 11 p.m. to 7:30 a.m. on weekends.

#### **Continuous Lane Closures/Traffic Shifts**

- Lane closure along southbound NW South River Dr between NW 91 Terr and NW 79 Ave.
- Southbound travel lanes along the NW 79 Ave bridge are reduced to two lanes.
- One northbound thru lane and one right-turn lane along NW South River Drive at the northbound S.R. 826/Palmetto Expressway off-ramp are removed.

***PLEASE NOTE THAT SCHEDULES MAY CHANGE DUE TO WEATHER OR UNEXPECTED CONDITIONS.***

---

### **PLAN YOUR COMMUTE!**

View the corridor wide traffic patterns and lane closures by clicking below:

[Online Map](#)

---

**[FOR MORE INFORMATION](#)**

Contact Community Outreach Specialist Veronica Briceno at [veronica.briceno@dot.state.fl.us](mailto:veronica.briceno@dot.state.fl.us) or at (954) 548-2754

Drivers are encouraged to log onto [www.fl511.com](http://www.fl511.com) to get real-time traffic and lane closure information.

[Corridor Wide Website](#)



Florida Department of Transportation, District Six | 1000 NW 111 Avenue | Miami, FL 33172 US

[Unsubscribe](#) | [Constant Contact Data Notice](#)