



Florida Department of Transportation  
**DISTRICT SIX CONSTRUCTION**  
Miami-Dade & Monroe counties



**State Road (S.R.) 25/U.S. 27/Okeechobee Road  
Corridor Wide Construction Update**

Below is a list of upcoming and ongoing construction activities and lane closure information for each project segment.

---

**NIGHTTIME INTERMITTENT LANE CLOSURES FOR SIGNALIZATION WORK**

**Okeechobee Road and Southbound S.R. 826/Palmetto Expressway Off-ramp**

On **Monday, March 16 and Tuesday, March 17, 2026**, intermittent lane closures will occur at the intersection of Okeechobee Road and the southbound SR 826/Palmetto Expressway off-ramp for traffic signal modifications. Work will occur from 11 p.m. to 5:30 a.m. Off-duty police officers will be onsite to assist with traffic control.

**Okeechobee Road and NW 95 Street**

On **Wednesday, March 18 and Thursday, March 19, 2026**, intermittent lane closures will occur at the intersection of Okeechobee Road and NW 95 Street for traffic signal modifications. Work will take place from 11 p.m. to 5:30 a.m. Off-duty police officers will be onsite to assist with traffic control.

---

**COMING SOON: CONTINUOUS CLOSURE ALONG NW 95 STREET**

Starting on **Friday, March 20, 2026, at 11 p.m.**, travel lanes in both directions along NW 95 Street between Frontage Road and NW 80 Avenue will be closed to traffic continuously for two weeks. Travel lanes are expected to open on **Monday, March 30, 2026, at 5:30 a.m.** This closure is necessary for the reconstruction of NW 95 Street.

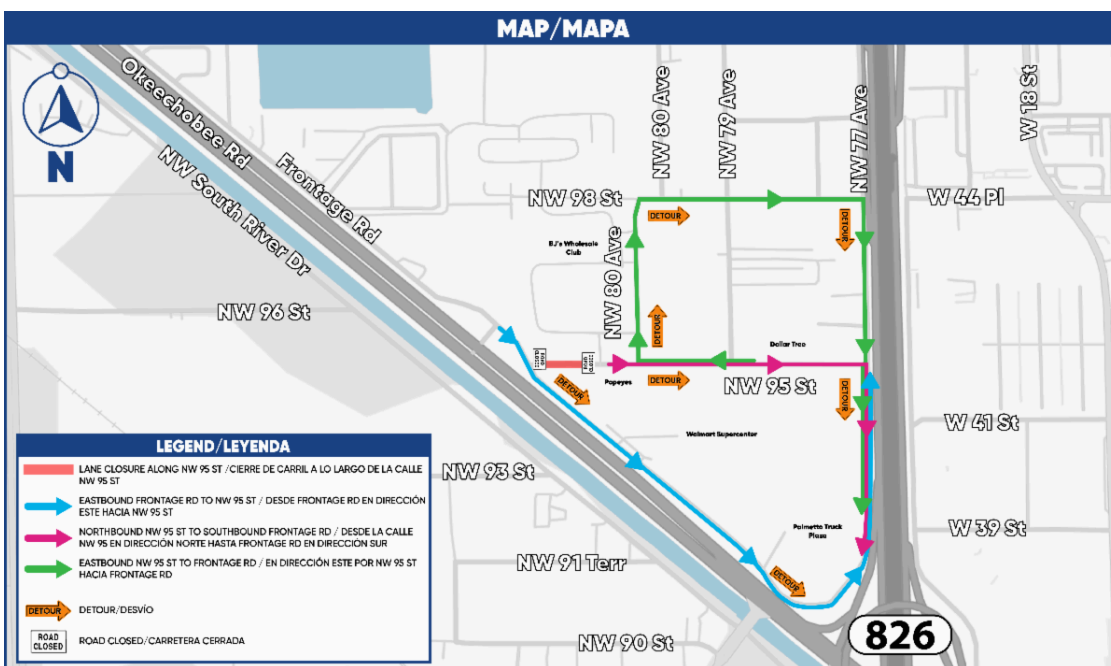
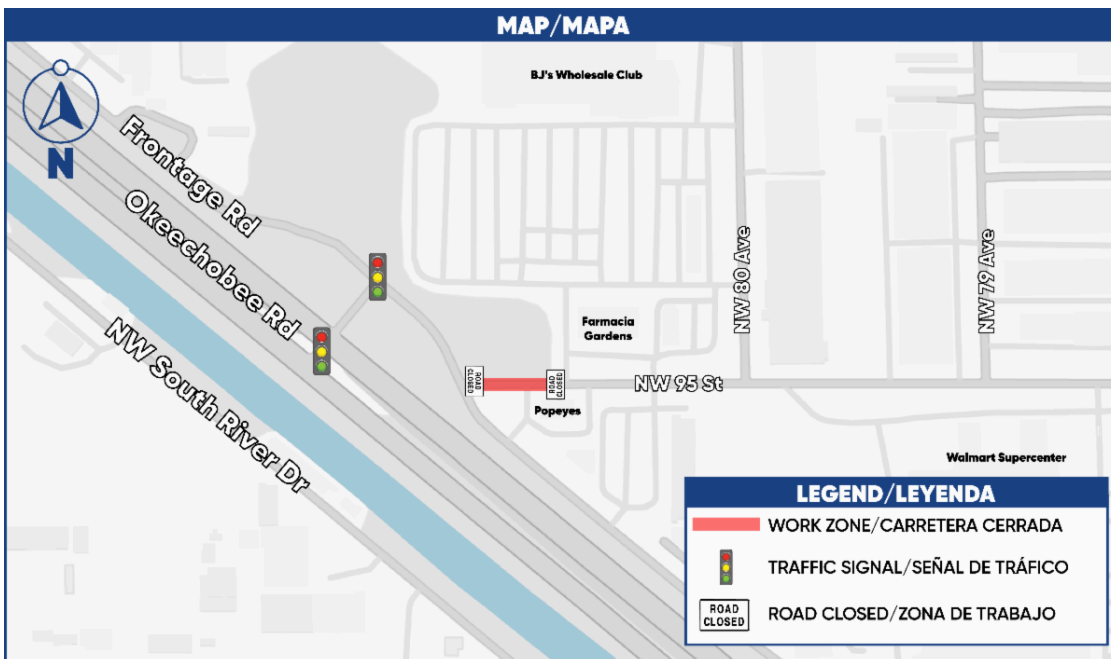

### ONGOING CONSTRUCTION ACTIVITIES

#### Segment Three: From east of NW 87 Ave to NW 74 St, including Palmetto Expy.

- Performing drainage work along S.R. 25/U.S. 27/Okeechobee Rd, Frontage Rd, NW South River Dr, and NW 79 Ave.
- Installing and performing the following:
  - Curb and gutter, excavation, and signalization work along Frontage Rd.
  - Temporary paving, backfilling, foundation and utility work along Okeechobee Rd.
  - Clearing and grubbing along the canal between NW 95 St and NW 79 Ave for roadway widening.
- Bridge construction at:
  - Okeechobee Rd and NW 79 Ave.
  - Bridge foundations along NW South River Dr between NW 79 Avenue and southbound S.R. 826/Palmetto Expy. on ramp.
  - NW South River Dr. and northbound S.R. 826/Palmetto Expy. off ramp.

- MSE wall for southbound S.R. 826/Palmetto Expy. on ramp.

During this time, single lane closures may take place along Frontage Rd and Okeechobee Rd in both directions.

Please note, utility companies are also performing relocations efforts along:

- Frontage Rd.
- West 18 Ave.

### General Lane Closures

Closures may take place during the following hours:

- 9 a.m. to 3:30 p.m. weekdays and weekends.
- 9 p.m. to 5:30 a.m. on weekdays.
- 11 p.m. to 7:30 a.m. on weekends.

### Continuous Lane Closures/Traffic Shifts

- Lane closure along southbound NW South River Dr between NW 91 Terr and NW 79 Ave.
- Southbound travel lanes along the NW 79 Ave bridge are reduced to two lanes.
- One northbound thru lane and one right-turn lane along NW South River Drive at the northbound S.R. 826/Palmetto Expressway off-ramp are removed.

***PLEASE NOTE THAT SCHEDULES MAY CHANGE DUE TO WEATHER OR UNEXPECTED CONDITIONS.***

---

### [PLAN YOUR COMMUTE!](#)

View the corridor wide traffic patterns and lane closures by clicking below:

[Online Map](#)

---

### [FOR MORE INFORMATION](#)

Contact Community Outreach Specialist Veronica Briceno at [veronica.briceno@dot.state.fl.us](mailto:veronica.briceno@dot.state.fl.us) or at (954) 548-2754

Drivers are encouraged to log onto [www.fl511.com](http://www.fl511.com) to get real-time traffic and lane closure information.

[Corridor Wide Website](#)

