



## Florida Department of Transportation

RON DESANTIS  
GOVERNOR

1000 N.W. 111 Avenue  
Miami, Florida 33172

JARED W. PERDUE, P.E.  
SECRETARY

**For Immediate Release**

October 5, 2022

**Contact: Tish Burgher**

(305) 470-5277 | [Tish.Burgher@dot.state.fl.us](mailto:Tish.Burgher@dot.state.fl.us)

### **Upcoming Traffic Shift of Frontage Road between NW 122 Avenue and NW 98 Avenue**

*October 6*

**MIAMI, Fla.** – On Thursday, October 6, 2022, travel lanes along Frontage Road between NW 122 Avenue and NW 98 Avenue will be shifted south on to temporary pavement. This shift will allow the crew to perform roadway widening and the installation of drainage, signalization, lighting and Intelligent Transportation Systems. The traffic shift will be in place until spring of 2023. Access to businesses and neighborhoods will be maintained at all times.

**Please note that this schedule may change due to bad weather or other unforeseen conditions.**

This project is part of the corridor wide reconstruction of the SR 25/US 27/Okeechobee Road from the Broward County Line to SR 826/Palmetto Expressway. This work will improve safety, enhance mobility along this Strategic Intermodal Systems (SIS) corridor, and inspire innovative transportation solutions, connecting commuters throughout Miami-Dade County.

For more information about the project or closure, please contact Senior Community Outreach Specialist Maria Alzate at (305) 560-8218 or by email at [Maria@iscprgroup.com](mailto:Maria@iscprgroup.com). You can also visit the project website: [www.fdotmiamidade.com/okeechobee](http://www.fdotmiamidade.com/okeechobee).

Drivers are encouraged to log on to [www.fl511.com](http://www.fl511.com) before they travel to get real-time traffic and lane closure information. The Florida Department of Transportation reminds motorists to always drive safely and avoid distractions while driving. Remember to put down cell phones. Florida law restricts motorists from using a wireless device in a school zone or an active construction zone.

**[Detour Map](#)**

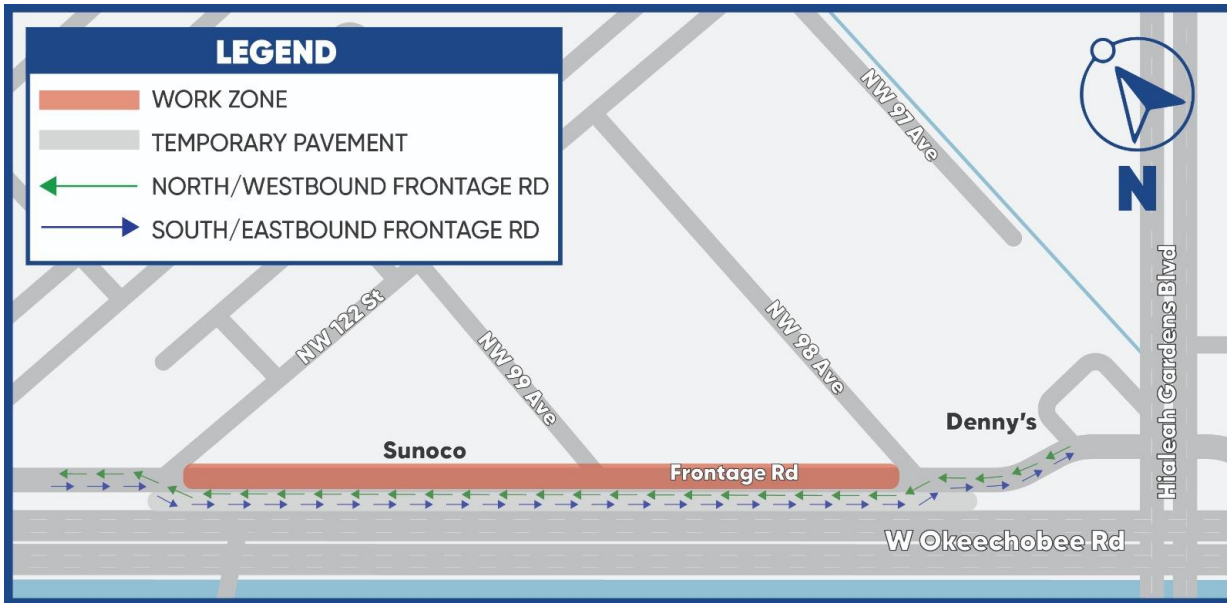

###

[FDOTMiamiDade.com](http://FDOTMiamiDade.com) | [@MyFDOT\\_Miami](https://www.instagram.com/MyFDOT_Miami) | [Facebook.com/MyFDOTMiami](https://www.facebook.com/MyFDOTMiami)

*The Florida Department of Transportation's mission is to provide a safe transportation system that ensures the mobility of people and goods, enhances economic prosperity, and preserves the quality of the state's environment and communities. The department is committed to building a transportation system that not only fits the current needs of Florida's residents and visitors, but also enhances mobility throughout the state to accommodate its consistent and rapid growth. The unique nature of the Sunshine State and its year-round warm climate provides numerous opportunities to achieve the department's mission through multiple transportation modes including highways/streets, air, rail, sea, spaceports, transit, and the ever-expanding deployment of bicycle & pedestrian facilities*