



Florida Department of Transportation

RON DESANTIS
GOVERNOR

1000 N.W. 111 Avenue
Miami, Florida 33172

JARED W. PERDUE, P.E.
SECRETARY

For Immediate Release

May 16, 2023

Contact: Tish Burgher

(305) 470-5277 | Tish.Burgher@dot.state.fl.us

The NW 116 Way Bridge will be Closed for a Traffic Shift *May 19 to May 22, 2023*

MIAMI, Fla. – On Monday, May 22, 2023, all travel lanes along the NW 116 Way bridge, between State Road (SR) 25/US 27/Okeechobee Road and NW South River Drive, will be shifted west while the contractor begins the demolition and reconstruction efforts on the east side of the bridge. Two travel lanes will be maintained in each direction. This shift will be implemented 24 hours, 7 days a week for approximately six months.

In order to safely implement the traffic shift, the bridge will be fully closed from 9 p.m. on Friday, May 19 to 5 a.m. on Monday, May 22, 2023. The following detours will be in place:

- Motorists heading northbound on NW 116 Way who wish to access Okeechobee Road will be detoured to go east on to NW 106 Terrace, continue to NW 106 Street, turn right on to NW South River Drive, turn left on to NW 105 Way and proceed on to Okeechobee Road.
- Motorists heading southbound on Hialeah Gardens Boulevard toward Okeechobee Road who wish to continue onto NW 116 Way will have to turn left on Okeechobee Road, make a right at NW 105 Way, make a right on to NW South River Drive, turn left on NW 106 Street to access NW 116 Way.
- Motorists traveling along Okeechobee Road who wish to access NW 116 Way will be detoured to the NW 105 Way intersection, make a right on to NW South River Drive, turn left on NW 106 Street to access NW 116 Way.
- Local access will only be provided to motorists wishing to access NW South River Drive between NW 116 Way to NW 121 Way.

Please note that this schedule may change due to bad weather or other unforeseen conditions.

This project is part of the corridor-wide reconstruction of the SR 25/US 27/Okeechobee Road from the Broward County Line to SR 826/Palmetto Expressway. This work will improve safety, enhance mobility along this Strategic Intermodal Systems (SIS) corridor, and inspire innovative transportation solutions, connecting commuters throughout Miami-Dade County.

For additional information, please call FDOT's Public Information Office at (305) 470-5349 or contact the Senior Community Outreach Specialist Maria Alzate at (305) 560-8218 or by email at Maria@iscprgroup.com. You can also visit the project website: www.fdotmiamidade.com/okeechobee.

Drivers are encouraged to log on to www.fl511.com before they travel to get real-time traffic and lane closure information. The Florida Department of Transportation reminds motorists to always drive safely and avoid distractions while driving. Remember to put down cell phones. Florida law restricts motorists from using a wireless device in a school zone or an active construction zone.

###

FDOTMiamiDade.com | [@MyFDOT_Miami](https://twitter.com/MyFDOT_Miami) | [Facebook.com/MyFDOTMiami](https://www.facebook.com/MyFDOTMiami)

The Florida Department of Transportation's mission is to provide a safe transportation system that ensures the mobility of people and goods, enhances economic prosperity, and preserves the quality of the state's environment and communities. The department is committed to building a transportation system that not only fits the current needs of Florida's residents and visitors, but also enhances mobility throughout the state to accommodate its consistent and rapid growth. The unique nature of the Sunshine State and its year-round warm climate provides numerous opportunities to achieve the department's mission through multiple transportation modes including highways/streets, air, rail, sea, spaceports, transit, and the ever-expanding deployment of bicycle & pedestrian facilities

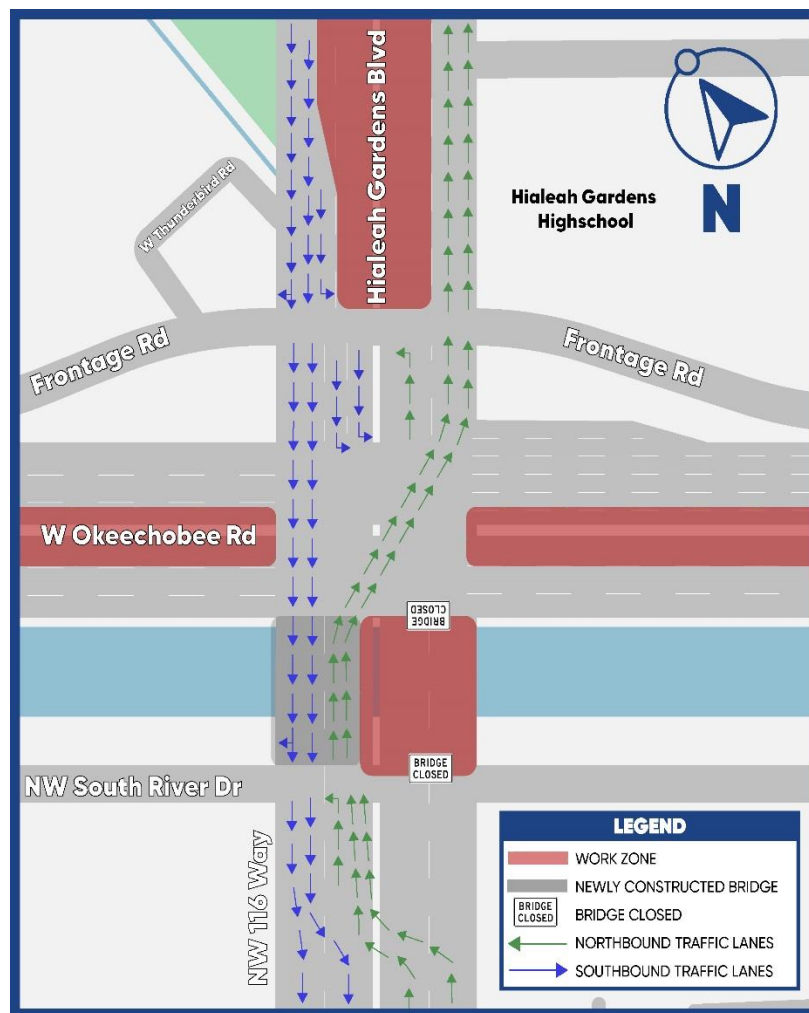

DETOUR MAP

