



**STAY INFORMED**

For more information please contact  
Community Outreach Specialist  
Dayana Sanjurjo  
786-239-8862  
Dayana.Sanjurjo@dot.state.fl.us

**VISIT US:**

[www.fdotmiamidade.com/wrongway](http://www.fdotmiamidade.com/wrongway)  
[www.fdot.tips/wrongway](http://www.fdot.tips/wrongway)

**FOLLOW US:**

@MYFDOT\_Miami  
 @MyFDOTMiami

**QR CODE**



# Wrong-Way Vehicle Detection Systems

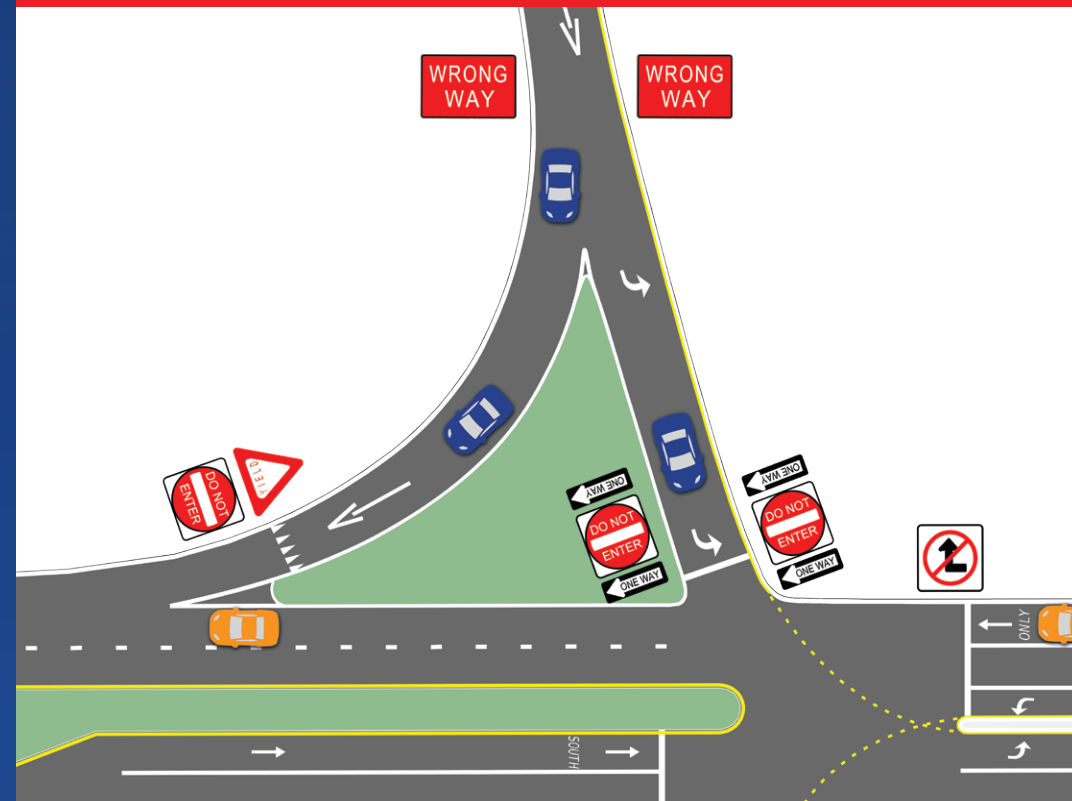

## WRONG-WAY VEHICLE DETECTION SYSTEMS

FDOT has begun phase 1 of the construction of a new detection system at 11 ramps throughout Miami-Dade County in May 2023, as part of an ongoing Statewide Wrong-Way Driving Initiative.

This new system is beign installed at the following ramps:

- |   |   |
|---|---|
| ① SR 9A/I-95 NB off-ramp to NW 151 Street       | ⑦ SR 826 NB/SR 836 EB off-ramp to NW 72 Avenue                    |
| ② SR 9A/I-95 SB off-ramp to Opa-Locka Boulevard | ⑧ SR 826 NB off-ramp to West Flagler Street                       |
| ③ SR 9A/I-95 SB off-ramp to NW 81 Street        | ⑨ SR 826 NB off-ramp to SW 8 Street                               |
| ④ SR 9A/I-95 SB off-ramp to NW 69 Street        | ⑩ SR 112/I-195/Julia Tuttle Causeway off-ramp to Alton Road North |
| ⑤ SR 826 NB off-ramp to NW 36 Street            | ⑪ SR 93/I-75 SB off-ramp to NW 138 Street/West 84 Street          |
| ⑥ SR 826 NB off-ramp to NW 25 Street            |   |

### RAMP LOCATION MAP

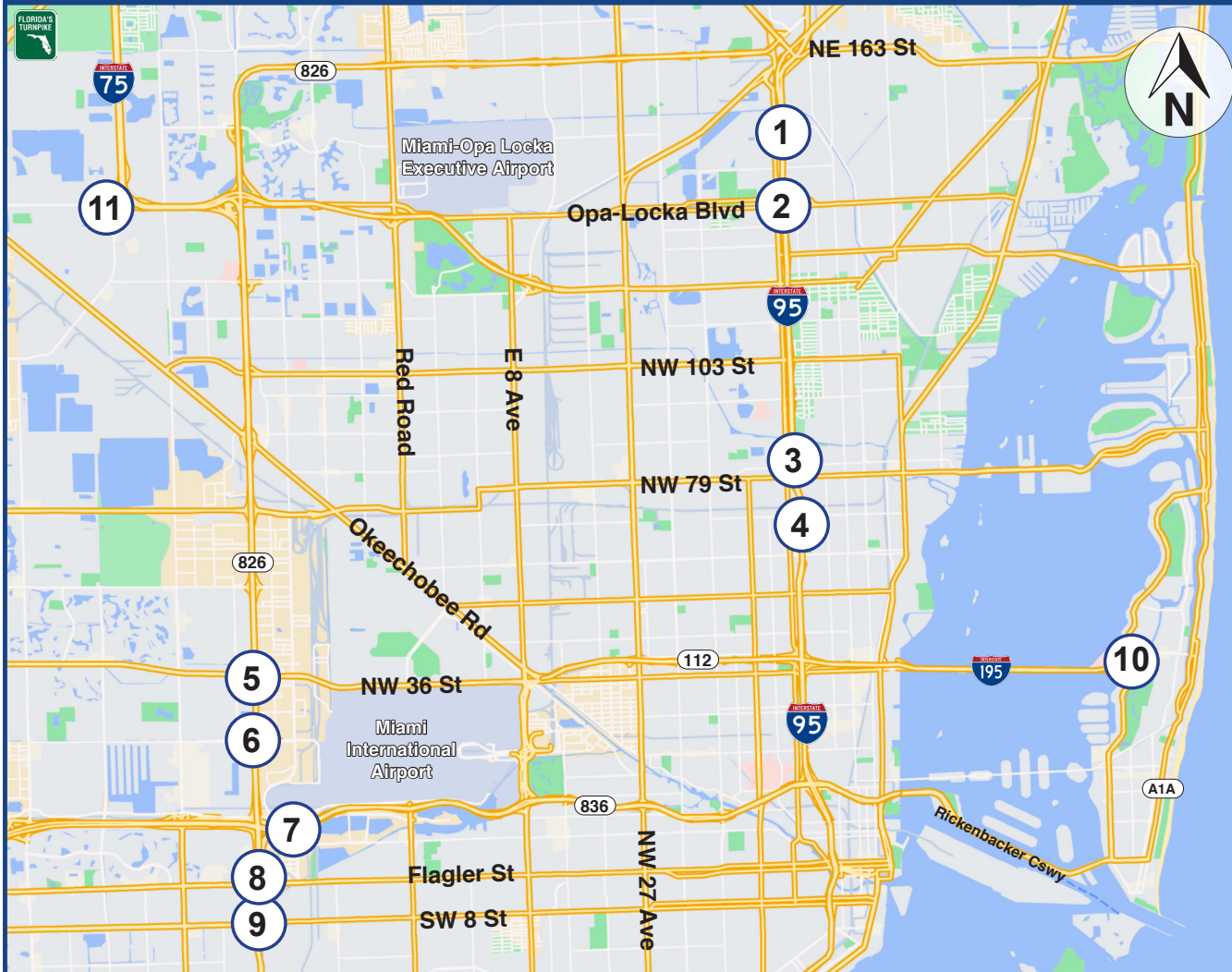

### BEFORE ENTERING RAMP

See This

Do This



Do Not Turn Right



Do Not Turn Left



Do Not Enter Ramp



### IF YOU ENTERED RAMP

See This

Do This



STOP

Pull Over

Turn Around

Call \*FHP for assistance, if needed

### IF YOU SEE A WRONG-WAY DRIVER



Use Caution

Reduce Speed

Pull Over

Call 911

[fdot.tips/wrongway](https://www.fdot.com/tips/wrongway)